



### Boost Your Performance

Panasonic professional LED displays are loaded with features to make working, communicating, and getting results easy. From the touch-panel and whiteboard functions of the LFB70 Series—which allow you to get to work instantly, writing on and saving documents, with no need for a connected PC—to the ultra-flexible wireless features of the LFC70 Series, these displays give you a genuine advantage by letting you work smarter, faster, and more effectively.



#### Product Specification

Model No.	TH-80LFB70	TH-65LFB70	TH-50LFB70	TH-80LFC70	TH-65LFC70	TH-50LFC70
<b>DISPLAY PANEL</b>						
Screen Size (Diagonal)	80-inch (2,032 mm)	65-inch (1,638 mm)	50-inch (1,267 mm)	80-inch (2,032 mm)	65-inch (1,638 mm)	50-inch (1,267 mm)
Panel Type	E-LED					
Aspect Ratio	16:9					
Effective Display Area (WxH)	1,771 x 996 mm (69.7" x 39.2")	1,428 x 803 mm (56.2" x 31.6")	1,095 x 616 mm (43.1" x 24.2")	1,771 x 996 mm (69.7" x 39.2")	1,428 x 803 mm (56.2" x 31.6")	1,095 x 616 mm (43.1" x 24.2")
Number of Pixels (kV)	1,020 x 1,280 pixel					
Brightness	250 cd/m <sup>2</sup>					
Contrast Ratio	5,000:1	5,000:1	5,000:1	4,000:1	4,000:1	5,000:1
Response Time	4 ms (G to G)	6.5 ms (G to G)	6.5 ms (G to G)	4 ms (G to G)	6.5 ms (G to G)	6.5 ms (G to G)
Viewing Angle	170 degrees	170 degrees	170 degrees	170 degrees	170 degrees	170 degrees
Panel Life*	Approx. 50,000 hours*	Approx. 50,000 hours*	Approx. 50,000 hours*	Approx. 50,000 hours*	Approx. 50,000 hours*	Approx. 50,000 hours*
*Approximate time until panel brightness decreases to half of its original value.						
<b>TOUCH PANEL</b>						
Detection Method	Infrared blocking detection method					
PC Connection Port	USB (3.0 compliant)					
<b>CONNECTION TERMINAL</b>						
VIDEO IN	RNC x 1					
AUDIO IN (L/R)	Stereo mini jack x 1 (Shared with COMPONENT/RGB IN)					
HDMI IN	HDMI TYPE A connector x 2					
COMPONENT (RGB) IN	S-Video x 1					
AUDIO IN (L/R)	Stereo mini jack x 1 (Shared with VIDEO IN)					
DVI-D IN	DVI-D 24-pin (signal) x 1					
AUDIO (L/R)	Stereo mini jack x 1 (Shared with PC IN)					
PC IN	Mini-D-sub 15-pin (Female) x 1, Plug & Play (VESA DDC 2B)					
AUDIO IN (L/R)	Stereo mini jack x 1 (Shared with DVI-D IN)					
PC OUT	Mini-D-sub 15-pin x 1					
Function Slot	8.0" QD 2.0" x 1					
USB A	USB TYPE A connector x 1 (For memory viewer)					
USB B	USB TYPE B connector x 1 (For Touch Panel)					
External Speaker	R.G. 20 W (10 W + 10 W) (10% THD)	R.G. 20 W (10 W + 10 W) (10% THD)	T.B.D.	R.G. 20 W (10 W + 10 W) (10% THD)	R.G. 20 W (10 W + 10 W) (10% THD)	T.B.D.
<b>CONTROL</b>						
SERIAL	D-sub 9-pin (male) x 1, RS-232C compatible					
DIGITAL LINK	RJ45 x 1 (Shared with LAN)					
LAN	RJ45 x 1, 100 Base-Tx, compatible with PoE+™ (Shared with DIGITAL LINK1)					
<b>AUDIO/ELECTRICAL</b>						
Sub-in Speaker	30 W (10 W + 10 W) (10% THD)					
Power Requirements	110–127 V AC, 50/60 Hz, 200–240 V AC, 50/60 Hz					
Power Consumption	360 W	T.B.D.	250 W	T.B.D.	T.B.D.	T.B.D.
Power Off Condition	Approx. 0.3 W					
Standby Condition	Approx. 0.5 W					
<b>MECHANICAL</b>						
Dimensions (WxHxD)	1,868 x 1,050 x 104 mm (73.5" x 41.3" x 4.1")	1,517 x 862 x 105 mm (59.7" x 33.7" x 4.1")	1,165 x 703 x 103 mm (46.7" x 27.6" x 4.1")	T.B.D.	1,482 x 867 x 92 mm (58.3" x 33.8" x 3.7")	1,149 x 669 x 89 mm (45.2" x 26.4" x 3.5")
Base Width	43 mm (1.7")	39 mm (1.6")	39 mm (1.6")	T.B.D.	T.B.D.	T.B.D.
Carton Dimensions (WxHxD)	2,075 x 1,310 x 454 mm (81.7" x 52.0" x 18.0")	T.B.D.	T.B.D.	T.B.D.	T.B.D.	T.B.D.
Weight	Approx. 65 kg/143 lbs.	T.B.D.	T.B.D.	T.B.D.	T.B.D.	T.B.D.
Gross Weight	Approx. 103 kg/227 lbs.	T.B.D.	T.B.D.	T.B.D.	T.B.D.	T.B.D.
Carton Material/Color	Aluminum/Black					
Pinch for Wall-Hanging	VESA compliant 400 x 400 mm (15.8" x 15.8")	684 x 300 mm (27.0" x 11.9")	400 x 300 mm (15.8" x 11.9")	VESA compliant 400 x 400 mm (15.8" x 15.8")	684 x 300 mm (27.0" x 11.9")	400 x 300 mm (15.8" x 11.9")
Protective Glass Thickness	Approx. 4 mm (0.16") 3A++ Glass	Approx. 3.2 mm (0.12") 3A++ Glass	Approx. 2.5 mm (0.10") 3A++ Glass	T.B.D.	T.B.D.	T.B.D.
<b>ENVIRONMENTAL</b>						
Operation Environment	Temperature: 0°C to 40°C (32°F to 104°F)					
Storage Environment	Temperature: -20°C to 60°C (-4°F to 140°F)					
Humidity	20% to 80% (Non-condensation)					
Included Accessories	AC cord, remote control transmitter, batteries for the remote control transmitter (AA size x 2), software CD-ROM (Whiteboard Software/ Wireless Manager Software/ Operating Instructions) x 1, USB cable x 1, Touch Pen x 4 (TH-80LFB70), Touch Pen x 2 (TH-65LFB70/50LFB70), Eraser x 1, Pen Stand, operating instruction book			AC cord, remote control transmitter, batteries for the remote control transmitter (AA size x 2), software CD-ROM (Wireless Manager Software/ Operating Instructions) x 1, operating instruction book		
<b>BUILT-IN WIRELESS LAN FUNCTION</b>						
Standard	3.4 GHz (IEEE802.11n), 5.0 GHz (IEEE802.11n/A)					
Infrastructure Mode	WPA2-PSK (TKIP/AES), WPA-PSK (TKIP/AES), WEP (64 bit/128 bit), WPA-EAP/WPA2-EAP (PEAP/ EAP-TLS MD5/MS-CHAPv2), 128-bit/64-bit					

#### Optional Accessories

Mobile Stand For 80-inch TY-ST80LFB70 For 65-inch TY-ST65LFB70 For 50-inch TY-ST50LFB70	For 80-inch TY-ST80P82 For 65-inch TY-ST65P82	Wall-Hanging Bracket For 80-inch TY-WK80P50 (Vertical) For 65-inch TY-WK65P820 (Vertical/Angled)	For 80-inch TY-WK42P20 (Vertical) For 65-inch TY-WK42P20 (Angled)	Pedestal For 80-inch/65-inch TY-ST80P20 For 65-inch TY-ST42P50	Ceiling Bracket For 65-inch TY-CE42P20	DIGITAL LINK Interface Box ET-YFB100G	Easy Wireless Stick ET-UW100
---	--	--	--	--	--	---	------------------------------------

#### Optional Function Board

Dual Video Terminal Board TY-FB98D	DVI-D Terminal Board TY-FB11DD	Dual HDMI Terminal Board TY-FB10HMD	HD-SDI Terminal Board TY-FB10HD	HD-SDI Terminal Board with Audio TY-FB10HD	Dual Link HD-SDI Terminal Board with Audio TY-FB1DHD	Plug-in PC Accessories and Europe only PLUGTHA54
--	--------------------------------------	---	---------------------------------------	--	--	--

## Panasonic



For more information about Panasonic professional displays, please visit:  
Global Web Site - [panasonic.net/prodisplays](http://panasonic.net/prodisplays)  
YouTube - [www.youtube.com/PanasonicProDisplay](http://www.youtube.com/PanasonicProDisplay)

Weights and dimensions shown are approximate. Specifications and appearance are subject to change without notice. Product availability differs depending on region and country. This product may be subject to export control regulations. Windows, Windows Vista and PowerPoint are trademarks of Microsoft Corporation in the United States and other countries. Android is a registered trademark or trademark of Google Inc., Mac OS X, iPod, iPhone, iPod touch and iTunes are trademarks of Apple Inc., registered in the U.S. and other countries. The iTunes trademark is also a registered trademark in Japan, the United States, and other countries and regions or registered trademarks. HDMI, the HDMI logo, and High-Definition Multimedia Interface are trademarks or registered trademarks of HDMI Licensing LLC in the United States and other countries. Creative Connect™ is a trademark of Creative Electronics, Inc. Wi-Fi and Miracast™ are trademarks or registered trademarks of Wi-Fi Alliance. KillSwitch™ is a trademark of the KillSwitch Alliance. All other trademarks are the property of their respective trademark owners. Images on screen are simulated. Use of the product shall be in compliance with all relevant and applicable copyright protection laws. Data or work entered by the user into the Product's external media (including but not limited to removable optical and photographic media) is the creation of the user employing the Product and shall be addressed for by the user, the author of the data or work. Panasonic has no right or authority to grant the Product user any license, rights, and titles to use, modify, copy, or distribute, etc., any data or work created by the user or used with express permission of the data or work's author(s). © 2013 Panasonic Corporation. All rights reserved.

All information included here is valid as of February 2014.

CT13-G02PF-LFB/LFC Printed in Japan.

# Panasonic

Preliminary  
**LFB70 Series**  
Multi-touch Screen LED Displays  
**LFC70 Series**  
Network LED Displays

## New Ideas for Creative Communication



## LED

Multi-touch Screen LED Displays  
80-inch TH-80LFB70  
65-inch TH-65LFB70  
50-inch TH-50LFB70

Network LED Displays  
80-inch TH-80LFC70  
65-inch TH-65LFC70  
50-inch TH-50LFC70

# TOUCH

A brilliant Full HD touchscreen absolutely anyone can use.



## Work Smarter

The LFB70 Series of professional Full HD displays incorporate intuitive touchscreen technology, fully interactive whiteboard functionality, and the very latest in wireless connectivity to allow you and your colleagues to work more closely as a team. These displays are loaded with the next-generation technology you need to be more productive, more efficient, and to achieve better quality results.



## LFB70 Series

Multi-touch Screen LED Display  
80-inch / 65-inch / 50-inch



## Simple Touch Control

Progress smoothly through your presentation using familiar touchscreen gestures to turn pages, zoom in and out content, and navigate through multimedia functions without need of a remote control. Whether using a fingertip to cue content for a presentation, or the stylus pen to jot down notes for the group, you'll be delighted at how this user-friendly touch interface makes complex tasks simple.



## Work Together On Screen

Built-in whiteboard software lets you turn on the display and start work right away—no need to connect a PC. Up to four people can write at a time, and you can save your pages and email them directly to anyone who missed the meeting. Notes can be made on almost anything, from video and photos to PowerPoint® and PDF documents, and then saved as an image file—simply brilliant for the office or classroom.



## More Productive Remote Meetings

With vibrant Full HD resolution and a wide display area, remote videoconference participants seem like they're in the room with you. Team members in remote locations can write detailed notes onto shared documents and solve problems in real time, just as they would when working together in the office. These powerful web and video conferencing capabilities reduce the need for travel, saving your organization time and money.

## Quick and Easy to Use LFB70

### Smooth Workflow from Start to Finish

The LFB70 Series features PC-Less Quick-Start Whiteboard technology, so you can switch on the display and start writing immediately—no need to connect a PC equipped with software. Write and draw with smooth, natural precision, just like you do with an ink marker—but unlike a regular whiteboard, you can save\* your pages to internal memory, external USB memory, or email them directly from the display. Navigating through your multimedia presentation is easy using familiar touchscreen gestures, making your LFB70 Series display an efficient tool for group communication.



## Whiteboard Software Extends Your Capabilities

Whiteboard Software™ for PC offers extra functionality for power users. As well as adding useful tools to the menu palette, the application's six-point touch interface\*\* enables a wider variety of gestures for smooth and intuitive control. Further highlights include:

- Three operation modes\*\* (Whiteboard Function, PowerPoint® Link Mode, and Desktop Operation)
- Recorder function\*\*
- Image capture
- File operation (import and save)
- Presentation tool\*\* (zoom, spotlight, shade, fade-out marker)

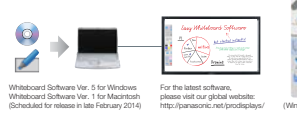

Whiteboard Software Ver. 5 for Windows  
Whiteboard Software Ver. 1 for Macintosh  
(Scheduled for release in late February 2014)



## Flexible and Versatile LFB70 LFC70



### Miracast™ for Instant Wireless Sharing

Transmit documents, Full HD video, images, and audio from compatible Android devices and Windows PCs to the big screen with Miracast™—the latest wireless standard that doesn't require software or complicated setup. With no cables, fast connection, and high bandwidth, Miracast™ makes it easy for everyone to contribute.



For list of tested Miracast™ compatible devices, please visit our global website:  
<http://panasonic.net/prodisplay/>

### Wireless Apps for iOS and PC\*\*

A free iOS app conveniently displays content from iPod touch®, iPhone®, and iPad® on the big screen, with no cables and no hassle. For PC users, Wireless Manager ME™ wirelessly transmits a variety of media (including audio\*\*) from your computer to the display. It includes a Multi-Live mode to facilitate the display of content from up to 16 PC or iOS devices simultaneously. Alternatively, you can plug an Easy Wireless Stick (ET-UW100\*) into your computer's USB port to send content wirelessly\*\*.



### Instant Playback of Content from USB

Playback of Full HD video, still images, and a range of digital documents from USB storage devices is quicker and easier than ever. Just insert the memory device into the display's USB port and start your presentation without having to connect a PC.

## SLOT 2.0 Expand and Customize with SLOT2.0

SLOT2.0 allows you to add the functions you need to perfectly suit almost any application. Optional function boards including HDMI, HD-SDI, and Plug-in PC can be mounted to support a customized content distribution system.



### Simplified DIGITAL LINK Connection

DIGITAL LINK uses HDBase™ technology to transmit uncompressed Full HD video, audio, and control commands through a single CAT5e cable for up to 100 m (328 ft).

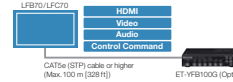

## Easy Connect a Second Display

Use a VGA cable to mirror\*\* content on a second display or projector—even the notes added to documents, images, or video during your presentation. This dual-display capability makes both the LFB70 and LFC70 series ideal for use in larger venues.



# CONNECT

A display that makes team communication more efficient and effective.



## Share and Collaborate

Make it easier for your team to share media content from smartphone, PC, and tablet on one of the industry's most advanced big-screen displays. A number of next-generation wireless technologies are included to support a wide variety of devices and media formats, so all members of your team can contribute to the flow of ideas in the office, classroom, or conference center.



## Wireless Options for Mobile and PC

It's simple to get documents from different network-attached devices—such as notebooks, smartphones, and tablets—onto the big screen. These pro displays are compatible with Miracast™ (which doesn't require any software to mirror certain content) as well as dedicated apps that get the media you want up and on screen faster, with no cables or complicated setup.

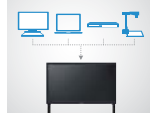

## Better Connectivity and Flexibility

With Panasonic's DIGITAL LINK, based on HDBase™ technology, and SLOT2.0 (which allows for easy installation and removal of customized terminal boards or a modular PC), it costs less money and time to set up the display exactly to your requirements. Compatibility with leading automation systems and switching devices lets you seamlessly integrate these displays into an existing A/V network.



## Superior Imaging Quality

Panasonic professional LED panels combine the best of both worlds—brilliant Full HD imaging performance and the remarkable efficiency of edge-lighting. Compared with conventional backlit screens, Panasonic edge-lit LED displays are able to deliver bright, punchy images while consuming less energy. Both the LFB70 and LFC70 produce an impressive 350 cd/m² of brightness for vividly clear pictures.

## LFC70 Series

Network LED Display  
80-inch / 65-inch / 50-inch



## Loaded with High-Value Features

- Picture-in-Picture Capability
- Toughened Glass for Durability
- Built-in 10 W + 10 W Speakers
- A Wide Range of Accessories to Fit Your Needs
- Support for Automation and Switching Systems



\*\* Can be saved and sent as JPG format only. \*\* Supported by Windows®/Windows Vista®/Windows 7®/Windows 8®/Windows 8.1 and Macintosh (Mac OS X 10.6/v10.7/v10.8/v10.9). Some functions are not supported on Macintosh version. \*\* For Windows only. \*\* Wireless display with devices that are not Miracast™ compatible or wireless display from multiple devices requires the installation of dedicated software. \*\* Supported by Windows®/Windows Vista®/Windows 7®/Windows 8® and Macintosh (Mac OS X v10.6/v10.7/v10.8/v10.9). \*\* Windows 7® and Windows Vista® users must log in using the Administrator's account. When a Windows 7®-equipped computer is first used, the sound driver may require adjustment. \*\* The ET-UW100 is available in the following countries and regions as of October 2013: North America, England, Germany, France, Spain, Italy, Belgium, Austria, Sweden, Norway, Denmark, Switzerland, Holland, Finland, Portugal, Greece, Australia, and Japan. \*\* The ET-UW100 will not transfer audio files. A firmware update is necessary to use the ET-UW100. For more information, please visit our Professional Display global website at <http://panasonic.net/prodisplay/>. \*\* Supports 1080p@60 signal only.