

Hideaway™ Surface Access Enclosures

HSA 400, HSA 402, HSA 822,
HSA 822M, & HSA 822MS



HSA 400



HSA 402



HSA 822



HSA 822M
Motorized



HSA 822MS
Motorized, Surface Matching

- Convenient access to connectors
- Simple ergonomic design
- Pneumatic or motorized movement and mechanical latching mechanism
- Surface top available in a variety of materials and finishes
- Two or four RJ-45 CAT 6 network/data/phone connectors
- Holds up to four or eight AAP – Architectural Adapter Plates
- One or two unswitched AC outlets
- Models available with US, UK, Australia, Europe, Switzerland, France, Israel, or India AC outlets
- UL/CUL listed and CE compliant

Extron HSA – Hideaway Surface Access enclosures are surface mountable, architectural solutions that provide inconspicuous access to computer-video interface controls and A/V connectors. Hideaway enclosures are designed for easy mounting into virtually any table surface. Once installed, HSA enclosures fit flush with the tabletop, storing interface and A/V connectors out of sight.



Extron® Electronics

www.extron.com

DESCRIPTION

The Extron **HSA - Hideaway™** Surface Access enclosures are out-of-sight solutions to interface access. The HSA family is comprised of four models: HSA 400, HSA 402, HSA 800, and HSA 802. Each HSA enclosure is designed for easy mounting through virtually any table surface. The rugged and reliable enclosure is small and compact; this minimizes installation time and effort. Once installed, the

HSA fits nearly flush with the tabletop, storing interface connectors out of sight. The HSA 400 Series products consist of single-sided, tilt-up enclosures, while the HSA 822 Series models are double-sided, vertically lifting enclosures. Both series provide inconspicuous computer-video interface and A/V connector access and control.

HSA 400

- Tilt-up Hideaway enclosure
- Durable pneumatic movement and mechanical latching mechanism
- One unswitched AC outlet
- Two female CAT 6 RJ-45 network/data/phone connectors
- Faceplate includes room for up to four single-space Extron AAPs - Architectural Adapter Plates



HSA 400
Opened



HSA 400 top view
Closed

HSA 402

- Tilt-up Hideaway enclosure
- Durable pneumatic movement and mechanical latching mechanism
- Two unswitched AC outlets
- Four female CAT 6 RJ-45 network/data/phone connectors
- Faceplate includes room for up to four single-space Extron AAPs - Architectural Adapter Plates



HSA 402
Opened



HSA 402 top view
Closed

HSA 822

- Vertically lifting Hideaway enclosure
- Durable pneumatic movement and mechanical latching mechanism
- Two unswitched AC outlets
- Four female CAT 6 RJ-45 network/data/phone connectors
- Double sided with opening on each side allowing for four single-space AAPs - Architectural Adapter Plates per side



HSA 822
Opened

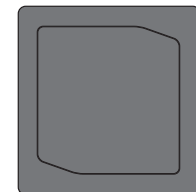

HSA 822 top view
Closed

HSA 822M & HSA 822MS

- Motorized vertically lifting Hideaway enclosure
- Safety mechanism prevents closing on obstructions
- Two unswitched AC outlets
- Four female CAT 6 RJ-45 network/data/phone connectors
- Double sided with opening on each side allowing for four single-space AAPs - Architectural Adapter Plates
- HSA 822MS allows matching table surface to be used



HSA 822 MS
Opened

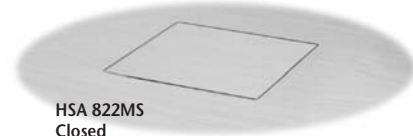

HSA 822MS
Closed

AC OUTLET OPTIONS

HSA models are available with the following AC outlet options:



Australia

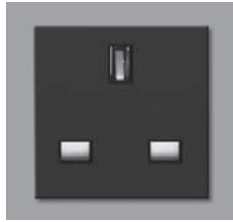

United Kingdom



Central Europe



Switzerland



USA



France



India



Israel

INSTALLATION

Extron iDemos are streaming and downloadable video demonstrations that provide step-by-step instructions for installing Extron HSA products. Because of its streaming format, the iDemo can be viewed directly from the Extron Web site and does not have to be downloaded, saving valuable time and disk space.



The iDemo will walk you through the installation process step-by-step.

Router Templates

Table surface preparation is easy. By using the proper Extron router templates and a router, you can make the necessary cut with little chance of error. Router templates are free and available from your Extron Customer Support Representative. Cutout templates and dimensions can be downloaded from the Extron Web site at www.extron.com.



Router Template



Flush Table Top Mounting

When installed, HSA enclosures fit flush with the tabletop, while a metal clamshell provides a strong and solid encasement underneath, storing connectors out of sight and minimizing additional hardware.

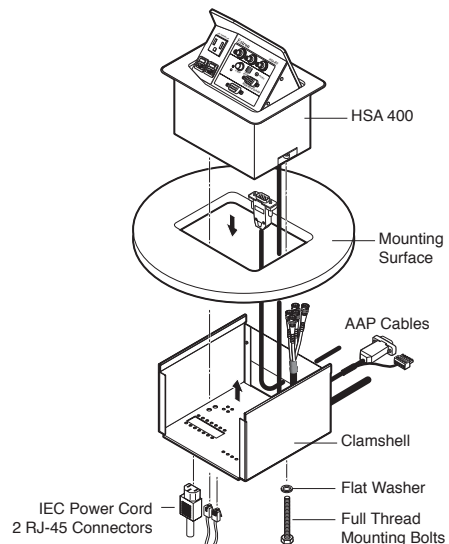

CONNECTIVITY OPTIONS

Versatile Extron AAP – Architectural Adapter Plates offer numerous possibilities for customized connectivity and control combinations. AAPs are module plates that fit into many Extron products, including the HSA line of products. AAPs allow passive pass-through connection, as well as active connection for audio, composite video, computer, data, and power. AAPs are available with popular video, audio, computer, phone, and control connectors. Blank AAP plates are supplied with each Hideaway Surface Access enclosure to fill empty slots. In addition, Extron has developed AAPs that include buttons and switches for control and operation.



The Extron Connectivity Configurator is an interactive, drag-and-drop, online tool for designing and customizing architectural connector installations. This tool presents a comprehensive list of every Extron AAP - Architectural Adapter Plate currently available. After selecting the appropriate style and color of mounting frame, users can easily sort through the hundreds of connector options, and simply drag and drop their selections into place. Users can print the resulting configuration for inclusion in customer presentations and documentation.

RGB 580XI REMOTE INTERFACE



RGB 580xi Remote Interface,
part # 60-362-01

The Hideaway Series can be combined with the unique Extron RGB 580xi interface to create a complete solution for computer-video interfacing and system input access. The RGB 580xi is a high performance universal, computer-video interface with audio and Advanced Digital Sync Processing—ADSP™. The RGB 580xi can be mounted in a remote location away from the input and controls, giving users discreet access to interface inputs and adjustments.

The RGB 580xi offers these features:

- Compatible with VGA-QXGA, Mac, Sun®, and SGI® signals
- 300 MHz (-3 dB) RGB video bandwidth
- Unique design allows out-of-sight mounting
- Connectors and controls accessible remotely through AAP - Architectural Adapter Plates

There are three HSA compatible configurations of RGB 580xi AAPs with user controls. Each gives system designers the flexibility to select which controls are needed for specific installations.



RGB 580xi AAP
15-pin HD & 3.5 mm
input connectors,
part # 70-128-02



RGB 580xi S AAP
Input connectors &
horizontal shift control,
part # 70-134-02



RGB 580xi SI AAP
Input connectors, input
selection, & horizontal
shift control,
part # 70-137-02

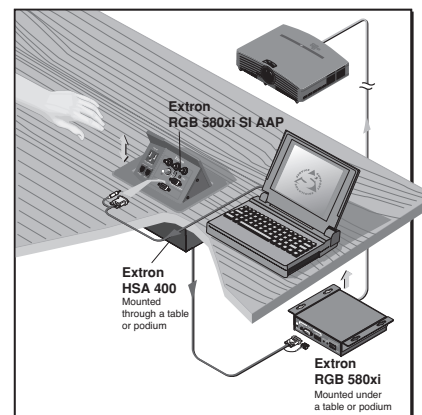

SPECIFICATIONS

CONTROL/REMOTE — HSA 822M, HSA 822MS

Contact closure..... (1) 3.5 mm female captive screw connector, 10 pole
 Contact closure pin configurations.. Pin 1 = up, pin 2 = down, pin 3 = stop, pin 5 = enable push operation, pin 6 = status up, pin 7 = status down, pin 9 = status power, pins 4, 8, and 10 = ground

GENERAL

Power (HSA 822M, HSA 822MS)..... 100 VAC to 240 VAC, 50/60 Hz, 25 watts, internal, autoswitchable
 Temperature/humidity (HSA 822M, HSA 822MS) Storage: -40 to +158 °F (-40 to +70 °C) / 10% to 90%, noncondensing
 Operating: +32 to +122 °F (0 to +50 °C) / 10% to 90%, noncondensing
 Rack mount..... No, but furniture mountable
 Enclosure type Metal

Clamshell dimensions diagrams

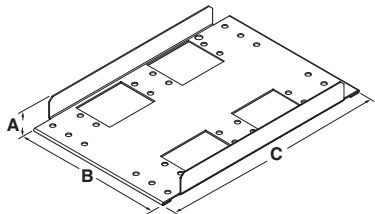

HSA 822MS

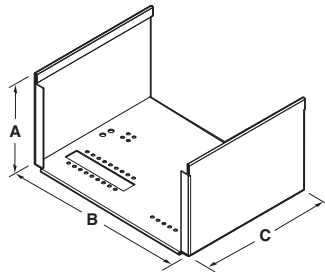

All other models

Enclosure dimensions

CAUTION: Use the appropriate metal Extron routing template or refer to the surface cutout dimensions here before cutting a hole in the furniture or other surface. Pay special attention to the direction the unit will face; the unit's AAP and connector access side is underlined. Installers, not Extron, are solely responsible for correctly cutting mounting holes.

HSA 400 (US)

Top plate (outer rim)..... 8.613" W x 6.425" D
 (21.88 cm W x 16.39 cm D)
 Top plate (tilt plate) 6.663" W x 4.475" D
 (16.92 cm W x 11.37 cm D)
 Surface cutout..... 8.113 ±0.0325" W (front) x 5.925
 ±0.0325" D (20.61 ±0.083 cm W x
 15.05 ±0.083 cm D)
 Clamshell (see diagram) A = 5.25" (13.3 cm)
 B = 7.75" (19.7 cm)
 C = 7.75" (19.7 cm)

HSA 402 (US)

Top plate (outer rim)..... 10.844" W x 6.425" D
 (27.54 cm W x 16.32 cm D)
 Top plate (tilt plate) 8.894" W x 4.475" D
 (22.59 cm W x 11.37 cm D)
 Surface cutout..... 10.344 ±0.0325" W (front) x
 5.925 ±0.0325" D (26.27 ±0.083 cm
 W x 15.05 ±0.083 cm D)
 Clamshell (see diagram) A = 5.25" (13.3 cm)
 B = 9.80" (24.9 cm)
 C = 7.75" (19.7 cm)

HSA 400 (International)

Top plate (outer rim)..... 10.113" W x 6.425" D
 (25.74 cm W x 16.32 cm D)
 Top plate (tilt plate) 8.163" W x 4.475" D
 (21.88 cm W x 11.37 ±0.083 cm D)
 Surface cutout..... 9.613 ±0.0325" W (front) x 5.925
 ±0.0325" D (24.42 ±0.083 cm W x
 15.05 ±0.083 cm D)
 Clamshell (see diagram)..... A = 5.25" (13.3 cm)
 B = 9.25" (23.5 cm)
 C = 7.75" (19.7 cm)

HSA 402 (International)

Top plate (outer rim)..... 13.844" W x 6.425" D
 (35.16 cm W x 16.32 cm D)
 Top plate (tilt plate) 11.894" W x 4.475" D (30.21 cm W
 x 11.37 cm D)
 Surface cutout..... 13.344 ±0.0325" W (front) x 5.925
 ±0.0325" D (33.89 ±0.083 cm W x
 15.05 ±0.083 cm D)
 Clamshell (see diagram) A = 5.25" (13.3 cm)
 B = 12.8" (32.5 cm)
 C = 7.75" (19.7 cm)

HSA 822, HSA 822M

Top plate (outer rim)..... 8.470" W x 8.750" D
 (21.51 cm W x 22.23 cm D)
 Top plate (vertically lifting plate) .. 6.220" W x 6.500" D
 (15.80 cm W x 16.51 cm D)
 Surface cutout..... 7.90 ±0.0325" W (AAP access from
 front and back) x 8.250" ±0.0325" D
 (20.07 ±0.083 cm W x 20.96
 ±0.083 cm D)
 Clamshell (see diagram) A = 7.24" (18.39 cm)
 B = 8.25" (21.0 cm)
 C = 10.98" (27.89 cm)

HSA 822MS

Top plate (outer rim)..... 9.54" W x 9.82" D
 (24.23 cm W x 24.94 cm D)
 Top plate (vertically lifting plate, not included—
 to be provided by customer) .. 6.14" W x 6.42" D
 (15.49 cm W x 16.31 cm D)
 Surface cutout..... 6.220 ±0.0325" W (AAP access from
 front and back) x 6.500" ±0.0325" D
 (15.80 ±0.083 cm W x 16.51
 ±0.083 cm D)
 Clamshell tray (see diagram) A = 1.09" (2.77 cm) (tray height)
 B = 7.30" (18.54 cm)
 C = 10.98" (27.89 cm)

Overall height under table including tray
 9.48" (24.1 cm)

Product weight

HSA 400, HSA 402 8.4 lbs (3.8 kg)
 HSA 822..... 8.8 lbs (4.0 kg)
 HSA 822M, HSA 822MS 10.0 lbs (4.5 kg)

Shipping weight

HSA 400, HSA 402 11 lbs (5 kg)
 HSA 822..... 15 lbs (7 kg)
 HSA 822M, HSA 822MS 17 lbs (8 kg)

Listings, certifications

HSA 822M, HSA 822MS CSA C/US
 All other models UL, CUL, CSA C/US
 Compliances CE

MTBF

HSA 400, HSA 402,
 HSA 822 (gas lift) 100,000 cycles
 HSA 822M, HSA 822MS
 (stepper motor) 100,000 cycles

Warranty 3 years parts and labor

PART NUMBERS

Model	Version Description	Part #
USA AC Outlet Models		
HSA 400	Brushed Black Anodized	60-415-01
HSA 400	Brushed Aluminum.....	60-415-03
United Kingdom AC Outlet Models		
HSA 400 UK	Brushed Black Anodized	60-700-0B
HSA 400 UK	Brushed Aluminum.....	60-700-1B
Israel AC Outlet Models		
HSA 400 ISRAEL	Brushed Black Anodized	60-700-0C
HSA 400 ISRAEL	Brushed Aluminum.....	60-700-1C
Central Europe AC Outlet Models		
HSA 400 EU	Brushed Black Anodized	60-700-0D
HSA 400 EU	Brushed Aluminum.....	60-700-1D
France AC Outlet Models		
HSA 400 FRANCE	Brushed Black Anodized	60-700-0E
HSA 400 FRANCE	Brushed Aluminum.....	60-700-1E
Australia AC Outlet Models		
HSA 400 AUS	Brushed Black Anodized	60-700-0F
HSA 400 AUS	Brushed Aluminum.....	60-700-1F
India AC Outlet Models		
HSA 400 INDIA	Brushed Black Anodized	60-700-0G
HSA 400 INDIA	Brushed Aluminum.....	60-700-1G
Swiss AC Outlet Models		
HSA 400 SWISS	Brushed Black Anodized	60-700-0H
HSA 400 SWISS	Brushed Aluminum.....	60-700-1H

Routing Templates (available upon request at no charge)

HSA 400 Routing Template	US.....	70-189-01
HSA 400 Routing Template	International.....	70-189-02

Included Accessories
RJ-45 connection kit; Blank AAP Plates - Single, 2; Blank AAP Plates - Double, 1

Model	Version Description	Part #
USA AC Outlet Models		
HSA 402	Brushed Black Anodized	60-416-02
HSA 402	Brushed Aluminum.....	60-416-03
United Kingdom AC Outlet Models		
HSA 402 UK	Brushed Black Anodized	60-699-0B
HSA 402 UK	Brushed Aluminum.....	60-699-1B
Israel AC Outlet Models		
HSA 402 ISRAEL	Brushed Black Anodized	60-699-0C
HSA 402 ISRAEL	Brushed Aluminum.....	60-699-1C
Central Europe AC Outlet Models		
HSA 402 EU	Brushed Black Anodized	60-699-0D
HSA 402 EU	Brushed Aluminum.....	60-699-1D
France AC Outlet Models		
HSA 402 FRANCE	Brushed Black Anodized	60-699-0E
HSA 402 FRANCE	Brushed Aluminum.....	60-699-1E
Australia AC Outlet Models		
HSA 402 AUS	Brushed Black Anodized	60-699-0F
HSA 402 AUS	Brushed Aluminum.....	60-699-1F
India AC Outlet Models		
HSA 402 INDIA	Brushed Black Anodized	60-699-0G
HSA 402 INDIA	Brushed Aluminum.....	60-699-1G
Swiss AC Outlet Models		
HSA 402 SWISS	Brushed Black Anodized	60-699-0H
HSA 402 SWISS	Brushed Aluminum.....	60-699-1H

Routing Templates (available upon request at no charge)

HSA 402 Routing Template	US.....	70-190-01
HSA 402 Routing Template	International.....	70-190-02

Included Accessories
RJ-45 connection kit; Blank AAP Plates - Single, 2; Blank AAP Plates - Double, 1

Model	Version Description	Part #
USA AC Outlet Models		
HSA 822	Brushed Black Anodized	60-570-01
HSA 822	Brushed Aluminum.....	60-570-03
United Kingdom AC Outlet Models		
HSA 822 UK	Brushed Black Anodized	60-687-0B
HSA 822 UK	Brushed Aluminum.....	60-687-1B
Israel AC Outlet Models		
HSA 822 ISRAEL	Brushed Black Anodized	60-687-0C
HSA 822 ISRAEL	Brushed Aluminum.....	60-687-1C
Central Europe AC Outlet Models		
HSA 822 EU	Brushed Black Anodized	60-687-0D
HSA 822 EU	Brushed Aluminum.....	60-687-1D

France AC Outlet Models		
HSA 822 FRANCE	Brushed Black Anodized	60-687-0E
HSA 822 FRANCE	Brushed Aluminum.....	60-687-1E
Australia AC Outlet Models		
HSA 822 AUS	Brushed Black Anodized	60-687-0F
HSA 822 AUS	Brushed Aluminum.....	60-687-1F
India AC Outlet Models		
HSA 822 INDIA	Brushed Black Anodized	60-687-0G
HSA 822 INDIA	Brushed Aluminum.....	60-687-1G
Swiss AC Outlet Models		
HSA 822 SWISS	Brushed Black Anodized	60-687-0H
HSA 822 SWISS	Brushed Aluminum.....	60-687-1H

Routing Templates (available upon request at no charge)

HSA 822 Routing Template	All Versions.....	70-191-01
--------------------------	-------------------	-----------

Included Accessories
RJ-45 connection kit; Blank AAP Plates - Single, 4; Blank AAP Plates - Double, 2

Model	Version Description	Part #
USA AC Outlet Models		
HSA 822M	Brushed Black Anodized	60-719-0A
HSA 822M	Brushed Aluminum.....	60-719-1A
United Kingdom AC Outlet Models		
HSA 822M UK	Brushed Black Anodized	60-719-0B
HSA 822M UK	Brushed Aluminum.....	60-719-1B
Israel AC Outlet Models		
HSA 822M ISRAEL	Brushed Black Anodized	60-719-0C
HSA 822M ISRAEL	Brushed Aluminum.....	60-719-1C
Central Europe AC Outlet Models		
HSA 822M EU	Brushed Black Anodized	60-719-0D
HSA 822M EU	Brushed Aluminum.....	60-719-1D
France AC Outlet Models		
HSA 822M FRANCE	Brushed Black Anodized	60-719-0E
HSA 822M FRANCE	Brushed Aluminum.....	60-719-1E
Australia AC Outlet Models		
HSA 822M AUS	Brushed Black Anodized	60-719-0F
HSA 822M AUS	Brushed Aluminum.....	60-719-1F
India AC Outlet Models		
HSA 822M INDIA	Brushed Black Anodized	60-719-0G
HSA 822M INDIA	Brushed Aluminum.....	60-719-1G
Swiss AC Outlet Models		
HSA 822M SWISS	Brushed Black Anodized	60-719-0H
HSA 822M SWISS	Brushed Aluminum.....	60-719-1H

Routing Templates (available upon request at no charge)

HSA 822M Routing Template	All Versions.....	70-191-01
---------------------------	-------------------	-----------

Included Accessories
RJ-45 connection kit; Blank AAP Plates - Single, 4; Blank AAP Plates - Double, 2

Model	Version Description	Part #
USA AC Outlet Models		
HSA 822MS	Brushed Black Anodized	60-721-0A
United Kingdom AC Outlet Models		
HSA 822MS UK	Brushed Black Anodized	60-721-0B
Israel AC Outlet Models		
HSA 822MS ISRAEL	Brushed Black Anodized	60-721-0C
Central Europe AC Outlet Models		
HSA 822MS EU	Brushed Black Anodized	60-721-0D
France AC Outlet Models		
HSA 822MS FRANCE	Brushed Black Anodized	60-721-0E
Australia AC Outlet Models		
HSA 822MS AUS	Brushed Black Anodized	60-721-0F
India AC Outlet Models		
HSA 822MS INDIA	Brushed Black Anodized	60-721-0G
Swiss AC Outlet Models		
HSA 822MS SWISS	Brushed Black Anodized	60-721-0H

Drilling Template (available upon request at no charge)

HSA 822MS Drilling Template	All Versions.....	70-451-01
-----------------------------	-------------------	-----------

NOTE: Router Templates are not available for the HSA 822MS

Included Accessories
RJ-45 connection kit; Blank AAP Plates - Single, 4; Blank AAP Plates - Double, 2

Optional Accessories

HSA 822 Flexible Conduit Adapter Kit.....	70-228-01
HSA 400/402, R1 & L1, RJ-11 Cable Kit	70-225-01
HSA 402/822, R2 & L2, RJ-11 Cable Kit	70-226-01



Extron Electronics, USA
1230 South Lewis Street
Anaheim, CA 92805
800.633.9876 714.491.1500
FAX 714.491.1517

Extron Electronics, Europe
Beeldschermweg 6C
3821 AH Amersfoort, The Netherlands
+800.3987.6673 +31.33.453.4040
FAX +31.33.453.4050

Extron Electronics, Asia
135 Joo Seng Rd. #04-01
PM Industrial Bldg., Singapore 368363
+800.7339.8766 +65.6383.4400
FAX +65.6383.4664

Extron Electronics, Japan
Kyodo Building, 16 Ichibancho
Chiyoda-ku, Tokyo 102-0082
Japan
+81.3.3511.7655 FAX +81.3.3511.7656